



QUICK REFERENCE GUIDE

These instructions are supplied as a guide only. They are intended for patients with diabetes who have been prescribed Sanofi insulins intended for use with a ClikSTAR® pen device. Always read the full instruction leaflet accompanying the pen. To ensure an accurate dose each time, please follow all the steps in the instruction booklet of the insulin cartridge you have been prescribed and ask your healthcare provider if you have any questions or concerns before using ClikSTAR®.

STEP 1. INSERT A NEW INSULIN CARTRIDGE

- Pull or twist off the pen cap.
- Unscrew the insulin cartridge holder from the pen body.
- Check your insulin – follow the instructions provided with your insulin cartridge to inspect the expiry date and condition of your insulin.
- Place the insulin cartridge in the cartridge holder.

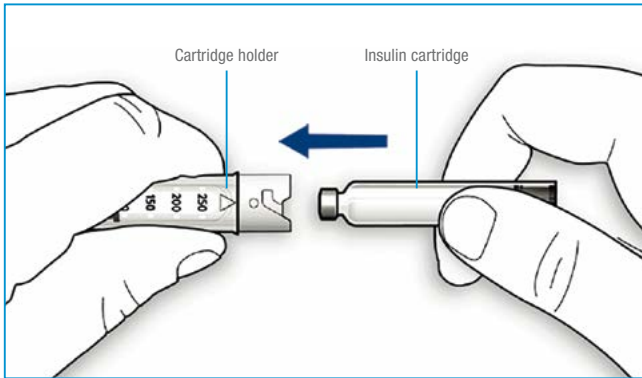

- Twist the insulin cartridge holder back on to the pen body. Make sure it clicks into place.

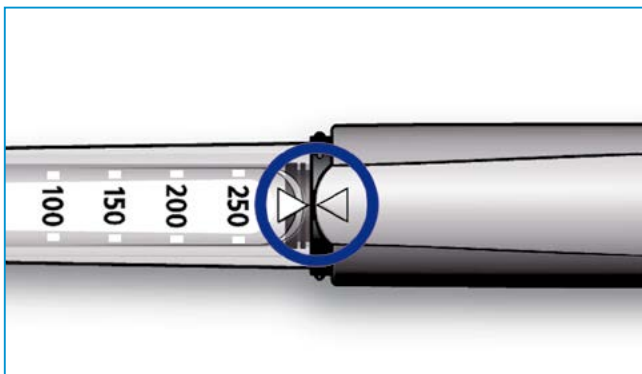
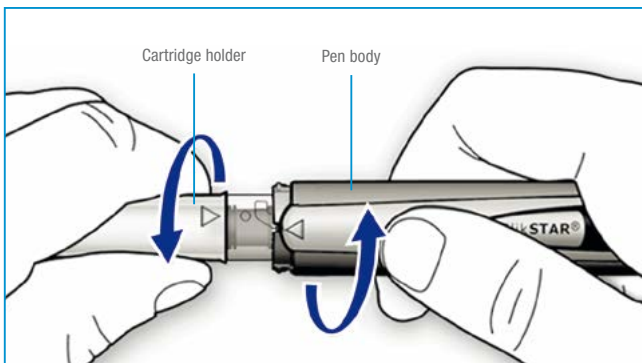

- ! CHECK** Make sure the alignment marks on the cartridge holder and the pen body are lined up.

STEP 2. ATTACH THE NEEDLE

! IMPORTANT Always use a new sterile needle for each injection. This helps prevent contamination, inaccurate dosing and needle blocks.

- Check the appearance of your insulin.
 - If you are using clear insulin, do not use the cartridge if the insulin is cloudy, coloured, or has particles
 - If you are using a suspension insulin, turn the pen up and down at least 10 times to resuspend the insulin. Turn the pen gently to avoid foaming in the cartridge
- Remove the protective seal from a new needle.
- Attach the pen needle to the cartridge holder. Keep it straight as you attach it. Screw or push on the needle, depending on the needle type you are using. (Please refer to the needle instruction leaflet).

- ! CHECK** Make sure that you attach the needle straight and firmly.

STEP 3. PERFORM A SAFETY TEST

! IMPORTANT Always perform a safety test before each injection to make sure that you get the correct insulin dose. The safety test removes air bubbles and ensures that pen and needle are working properly.

- Select a dose of 2 units by turning the dosage selector. The dose window will read '2'.
- Take off the outer needle cap. Take off the inner needle cap and discard it safely.
- Hold the pen with the needle pointing upwards. Tap the insulin cartridge holder so that any air bubbles rise up towards the needle.
- Press the injection button all the way in.

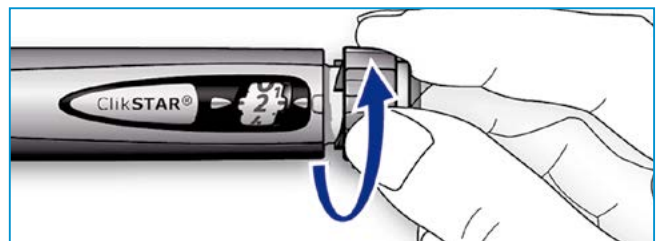

- ! CHECK** Check if insulin comes out of the needle tip.

! You may need to do this several times before you see insulin. If you have still not seen insulin come out of the needle tip:

- Change the needle
- Check that the cartridge is properly inserted and not damaged
- Repeat the safety test

If after this you still do not see insulin come out of the needle tip, do not use this ClikSTAR®.

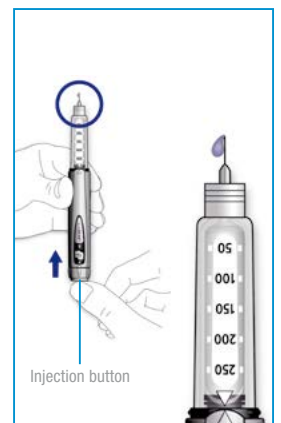



QUICK REFERENCE GUIDE

STEP 4. SELECT THE DOSE

You can set the dose in steps of 1 unit, from a minimum of 1 unit to a maximum of 80 units.

If you need a dose greater than 80 units, you should give it as two or more injections.

- A. Check that the dose window shows '0' following the safety test.
- B. Select your dose by turning the dosage selector.
 - If you turn past your dose, you can turn back down

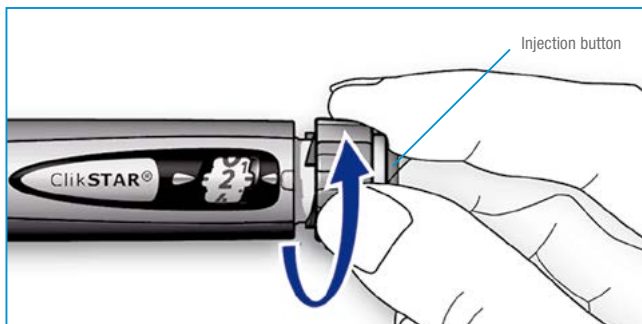

! IMPORTANT How to read the dose window:
 The maximum dose you can select is 80 units.
 The dose window shows even numbers.
 Odd numbers are shown as a line between even numbers.

STEP 5. GIVE THE INJECTION

Use the injection method as instructed by your healthcare provider.

- A. Insert the needle into the skin.
- B. Inject your dose by pressing the injection button slowly all the way in and wait for 10 seconds.

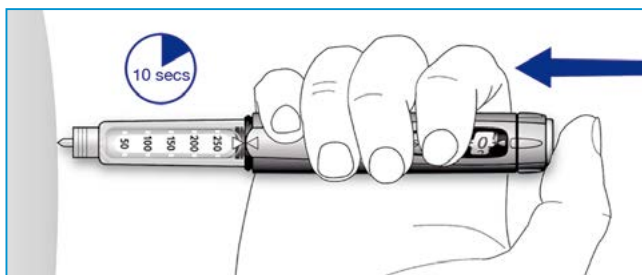
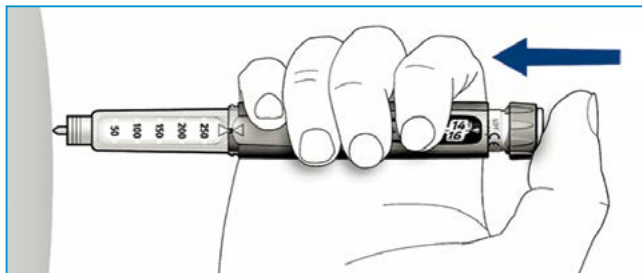

- C. Keep the injection button pressed all the way in. Slowly count to 10. Then remove the needle from the skin. If you have injected your entire dose, you will see '0' in the dose window.

! IMPORTANT To make sure that the full dose is injected, it is important that you press the injection button all the way in and keep pressing it for 10 seconds.

STEP 6. DISCARD OF PEN NEEDLE

- !**
- Always remove and discard the used needle after each injection. This helps prevent contamination, inaccurate dosing, and needle blocks
 - Take care to avoid touching the needle tip and, particularly, take care to prevent any other person risking infection by touching the needle tip
 - Remove needle and discard the needle exactly as shown by your healthcare provider

STEP 7. STORE CLIKSTAR®

- A. Replace the pen cap onto ClikSTAR® and store the pen until your next injection.

! IMPORTANT The insulin cartridge is re-usable. Your ClikSTAR® should be stored with the insulin cartridge attached, ready for your next injection.
 You should not store ClikSTAR® in the refrigerator. The insulin does not have to be kept in the refrigerator once it has been attached to ClikSTAR®, store at room temperature below 86°F (30°C).

Please check the instruction leaflet of your ClikSTAR® for additional information on how to store your pen.

Important information for use of ClikSTAR®:

- Always attach a new needle before each injection
- ClikSTAR® is only for your own use. Do not share it
- Always check you have the correct insulin type before injecting
- Do not use ClikSTAR® if it is damaged or if you are not sure that it is working properly
- Never use an insulin cartridge if it is damaged
- The alignment marks must be lined up with each other
- Always have a back-up method for delivering your insulin
- Do not insert a partially used cartridge

Reporting of side effects:

If you get any side effects, talk to your doctor, pharmacist or nurse. This includes any possible side effects not listed in the package leaflet. You can also report side effects directly via the Yellow Card Scheme at www.mhra.gov.uk/yellowcard. By reporting side effects you can help provide more information on the safety of this medicine.

www.diabetesmatters.co.uk

Freephone 24-hour Sanofi Diabetes care-line: 08000 35 25 25

Sanofi, One Onslow Street, Guildford, Surrey GU1 4YS